



Andy Beshear
GOVERNOR

TRANSPORTATION CABINET

200 Mero Street
Frankfort, Kentucky 40601

Jim Gray
SECRETARY

October 23, 2023

CALL NO. 111
CONTRACT ID NO. 231042
ADDENDUM # 1

Subject: Lawrence County, FBP 1203 (420)
Letting October 26, 2023

- (1) Revised - Proposal Bid Items - Pages 85-86 of 86
- (2) Revised Plans Sheets - S1, S7, and S9

Proposal revisions are available at <http://transportation.ky.gov/Construction-Procurement/>.

If you have any questions, please contact us at 502-564-3500.

Sincerely,

Rachel Mills,

A handwritten signature in cursive script that reads "Rachel Mills".

Rachel Mills, P.E.
Director
Division of Construction Procurement

RM:mr
Enclosures

PROPOSAL BID ITEMS

Report Date 10/23/23

Section: 0001 - PAVING

LINE	BID CODE	ALT	DESCRIPTION	QUANTITY	UNIT	UNIT PRIC	FP	AMOUNT
0010	00001		DGA BASE	333.00	TON		\$	
0020	00078		CRUSHED AGGREGATE SIZE NO 2	241.00	TON		\$	
0030	00100		ASPHALT SEAL AGGREGATE	3.00	TON		\$	
0040	00103		ASPHALT SEAL COAT	.40	TON		\$	
0050	00212		CL2 ASPH BASE 1.00D PG64-22	328.00	TON		\$	
0060	00301		CL2 ASPH SURF 0.38D PG64-22	64.00	TON		\$	
0070	00356		ASPHALT MATERIAL FOR TACK	.70	TON		\$	

Section: 0002 - ROADWAY

LINE	BID CODE	ALT	DESCRIPTION	QUANTITY	UNIT	UNIT PRIC	FP	AMOUNT
0080	01987		DELINEATOR FOR GUARDRAIL BI DIRECTIONAL WHITE	4.00	EACH		\$	
0090	02014		BARRICADE-TYPE III	2.00	EACH		\$	
0100	02091		REMOVE PAVEMENT	181.00	SQYD		\$	
0110	02159		TEMP DITCH	490.00	LF		\$	
0120	02160		CLEAN TEMP DITCH	245.00	LF		\$	
0130	02200		ROADWAY EXCAVATION	271.00	CUYD		\$	
0140	02242		WATER	1.00	MGAL		\$	
0150	02351		GUARDRAIL-STEEL W BEAM-S FACE	100.00	LF		\$	
0160	02367		GUARDRAIL END TREATMENT TYPE 1	4.00	EACH		\$	
0170	02429		RIGHT-OF-WAY MONUMENT TYPE 1	15.00	EACH		\$	
0180	02432		WITNESS POST	15.00	EACH		\$	
0190	02483		CHANNEL LINING CLASS II	168.00	TON		\$	
0200	02545		CLEARING AND GRUBBING 0.4 ACRES	1.00	LS		\$	
0210	02562		TEMPORARY SIGNS	54.00	SQFT		\$	
0220	02585		EDGE KEY	38.00	LF		\$	
0230	02602		FABRIC-GEOTEXTILE CLASS 1	725.00	SQYD		\$	
0240	02650		MAINTAIN & CONTROL TRAFFIC	1.00	LS		\$	
0250	02701		TEMP SILT FENCE	490.00	LF		\$	
0260	02703		SILT TRAP TYPE A	1.00	EACH		\$	
0270	02704		SILT TRAP TYPE B	1.00	EACH		\$	
0280	02706		CLEAN SILT TRAP TYPE A	1.00	EACH		\$	
0290	02707		CLEAN SILT TRAP TYPE B	1.00	EACH		\$	
0300	02726		STAKING	1.00	LS		\$	
0310	02731		REMOVE STRUCTURE	1.00	LS		\$	
0320	05950		EROSION CONTROL BLANKET	170.00	SQYD		\$	
0330	05952		TEMP MULCH	1,131.00	SQYD		\$	
0340	05953		TEMP SEEDING AND PROTECTION	848.00	SQYD		\$	
0350	05963		INITIAL FERTILIZER	.85	TON		\$	
0360	05964		MAINTENANCE FERTILIZER	.85	TON		\$	
0370	05985		SEEDING AND PROTECTION	1,526.00	SQYD		\$	
0380	05992		AGRICULTURAL LIMESTONE	1.05	TON		\$	
0390	06514		PAVE STRIPING-PERM PAINT-4 IN	1,936.00	LF		\$	
0400	20191ED		OBJECT MARKER TY 3	4.00	EACH		\$	

PROPOSAL BID ITEMS

Report Date 10/23/23

LINE	BID CODE	ALT	DESCRIPTION	QUANTITY	UNIT	UNIT PRIC	FP	AMOUNT
0410	25079ED		THRIE BEAM GUARDRAIL TRANSITION TL-2	4.00	EACH		\$	

Section: 0003 - BRIDGE

LINE	BID CODE	ALT	DESCRIPTION	QUANTITY	UNIT	UNIT PRIC	FP	AMOUNT
0420	02231		STRUCTURE GRANULAR BACKFILL	502.00	CUYD		\$	
0430	03299		ARMORED EDGE FOR CONCRETE	44.00	LF		\$	
0440	08003		FOUNDATION PREPARATION	1.00	LS		\$	
0450	08019		CYCLOPEAN STONE RIP RAP	995.00	TON		\$	
0460	08033		TEST PILES	111.00	LF		\$	
0470	08051		PILES-STEEL HP14X89	627.00	LF		\$	
0480	08095		PILE POINTS-14 IN	14.00	EACH		\$	
0490	08100		CONCRETE-CLASS A	111.80	CUYD		\$	
0500	08104		CONCRETE-CLASS AA	145.60	CUYD		\$	
0510	08151		STEEL REINFORCEMENT-EPOXY COATED (REVISED 10-23-23)	49,107.00	LB		\$	
0520	08160		STRUCTURAL STEEL 193,305 LBS	1.00	LS		\$	
0530	08170		SHEAR CONNECTORS 1158 LBS	1.00	LS		\$	
0540	23378EC		CONCRETE SEALING	7,301.00	SQFT		\$	
0550	23813EC		DECK DRAIN	2.00	EACH		\$	
0560	25028ED		RAIL SYSTEM SINGLE SLOPE - 40 IN	334.00	LF		\$	

Section: 0004 - DEMOBILIZATION &/OR MOBILIZATION

LINE	BID CODE	ALT	DESCRIPTION	QUANTITY	UNIT	UNIT PRIC	FP	AMOUNT
0570	02569		DEMOBILIZATION	1.00	LS		\$	

TRANSPORTATION CABINET DEPARTMENT OF HIGHWAYS

LAWRENCE COUNTY KY 581 OVER GEORGES CREEK STA. 12+68.00

ESTIMATE OF QUANTITIES

BID ITEM CODE	08100	08104	08019	08151	23813EC	02231	08170	08051	08033	08160	03299	25028ED	8095	23378EC	08003
BID ITEM	Concrete Class "A"	Concrete Class "AA"	Cyclopean Stone Rip Rap	Steel Reinforcement, Epoxy Coated	Deck Drain	Structure Granular Backfill	Shear Connectors	Piles - Steel HP 14 x 89	Test Piles	Structural Steel	Armored Edge for Concrete	Rail System Single Slope 40 Inch	Pile Point 14"	Concrete Sealing	Foundation Preparation
UNIT	C.Y.	C.Y.	Tons	LBS.	EA.	C.Y.	L.S.	L.F.	L.F.	L.S.	L.F.	L.F.	Each	S.F.	L.S.
End Bent #1	55.9		512	4772		251		310	55		22		7	404	
End Bent #2	55.9		483	4772		251		317	56		22		7	404	
Substructure															
Superstructure		145.6		39563	2										
BRIDGE TOTALS	111.8	145.6	995	49107	2	502	1	627	111	1	44	334	14	7301	1

① Estimated Weight of Structural Steel = 193,305 lbs.

② Estimated Number of Shear Connectors = 1158

INDEX OF SHEETS

Sheet No.	Description
S1	Title Sheet
S2	General Notes
S3	Layout
S4	Subsurface Data
S5	Foundation Layout
S6-S7	End Bent # 1
S8-S9	End Bent #2
S10	Bearing Details
S11-S13	Structural Steel Details
S14-S15	Superstructure
S16	Construction Elevations

SPECIAL NOTES

Special Note for Concrete Sealing

SPECIAL PROVISIONS

69 Embankment at Bridge End Bent Structures

STANDARD DRAWINGS

BGX-006-10 Stencils for Structures
 BGX-012-02 Geotechnical Legend
 BGX-015-04 Bridge Drains
 BJE-001-14 Neoprene Expansion Dams and Armored Edges
 BPS-011-04 HP14x89 Steel Pile
 BHS-010 Railing System 40 Inch Single Slope
 BGX-022 Joint Waterproofing

SPECIFICATIONS

2019 Standard Specifications for Road and Bridge Construction.

2020 AASHTO LRFD Bridge Design Specifications

ROUTE	ITEM NO.	COUNTY OF
KY 581	12-8701.00	LAWRENCE
	SHEET NO.	DRAWING NUMBER
	S1	28818

GENERAL NOTES

CROSSING
Georges Creek

DATE: JAN. 2023

DESIGNED BY: J. VAN ZEE

DETAILED BY: B. Miller

DATE

REVISION



COMMONWEALTH OF KENTUCKY
DEPARTMENT OF HIGHWAYS

TRANSPORTATION CABINET DEPARTMENT OF HIGHWAYS

LAWRENCE COUNTY KY 581 OVER GEORGES CREEK STA. 12+68.00

ESTIMATE OF QUANTITIES

BID ITEM CODE	08100	08104	08019	08151	23813EC	02231	08170	08051	08033	08160	03299	25028ED	8095	23378EC	08003				
BID ITEM	Concrete Class "A"	Concrete Class "AA"	Cyclopean Stone Rip Rap	Steel Reinforcement, Epoxy Coated	Deck Drain	Structure Granular Backfill	Shear Connectors	Piles - Steel HP 14 x 89	Test Piles	Structural Steel	Armored Edge for Concrete	Rail System Single Slope 40 Inch	Pile Point 14"	Concrete Sealing	Foundation Preparation				
UNIT	C.Y.	C.Y.	Tons	LBS.	E.A.	C.Y.	L.S.	L.F.	L.F.	L.S.	L.F.	L.F.	Each	S.F.	L.S.				
End Bent #1	55.9		512	4772		251		310	55		22		7	404					
End Bent #2	55.9		483	4772		251		317	56		22		7	404					
Substructure																			
Superstructure		145.6		39563	2														
BRIDGE TOTALS	111.8	145.6	995	49107	2	502	1	627	111	1	44	334	14	7301	1				

① Estimated Weight of Structural Steel = 193,305 lbs.

② Estimated Number of Shear Connectors = 1158

INDEX OF SHEETS

Sheet No.	Description
S1	Title Sheet
S2	General Notes
S3	Layout
S4	Subsurface Data
S5	Foundation Layout
S6-S7	End Bent #1
S8-S9	End Bent #2
S10	Bearing Details
S11-S13	Structural Steel Details
S14-S15	Superstructure
S16	Construction Elevations

SPECIAL NOTES

Special Note for Concrete Sealing

SPECIAL PROVISIONS

69 Embankment at Bridge End Bent Structures

STANDARD DRAWINGS

BGX-006-10 Stencils for Structures
 BGX-012-02 Geotechnical Legend
 BGX-015-04 Bridge Drains
 BJE-001-14 Neoprene Expansion Dams and Armored Edges
 BPS-011-04 HP14x89 Steel Pile
 BHS-010 Railing System 40 Inch Single Slope
 BGX-022 Joint Waterproofing

SPECIFICATIONS

2019 Standard Specifications for Road and Bridge Construction.

2020 AASHTO LRFD Bridge Design Specifications

BILL OF REINFORCEMENT

MARK	TYPE	NO.	SIZE	LENGTH	LOCATION	A	B	C	D
A1e	Str.	8	8	35'-8"	Cap.				
A2e	2s	5	8	37'-2"	Cap B.F.	35'-6 3/4"	1'-0"		
A3e	Str.	3	5	35'-8"	Cap F.F.				
A4e	14s	52	5	13'-0"	Cap/Wing Stirrup	3'-7"	2'-8"		
A5e	4	8	9	11'-5"	Cap Dowel Hook	9'-6 1/8"	1'-11"	0-11 3/4"	10'-0"
A6e	Str.	6	5	3'-7"	Wings F.F.				
A7e	5s	10	8	14'-11"	Wings B.F.	14'-1 3/8"	1'-0"		
A8e	Str.	10	8	14'-2"	Wings				
A9e	5s	4	8	16'-1"	Wings F.F.	14'-1 3/8"	2'-2"		
A10e	5s	6	5	16'-2"	Wings F.F.	14'-1 3/8"	2'-2"		
A11e	Str.	72	5	9'-7"	Wings Dowel				
A12e	5s	14	5	14'-3"	Wings B.F.	11'-7"	2'-9"		
A13e	5s	14	5	19'-3"	Wings F.F.	14'-1"	5'-3"		
A14e	5s	2	6	14'-2"	Top of Wings B.F.	11'-7"	2'-9"		
A15e	5s	2	6	19'-2"	Top of Wings F.F.	14'-1"	5'-3"		

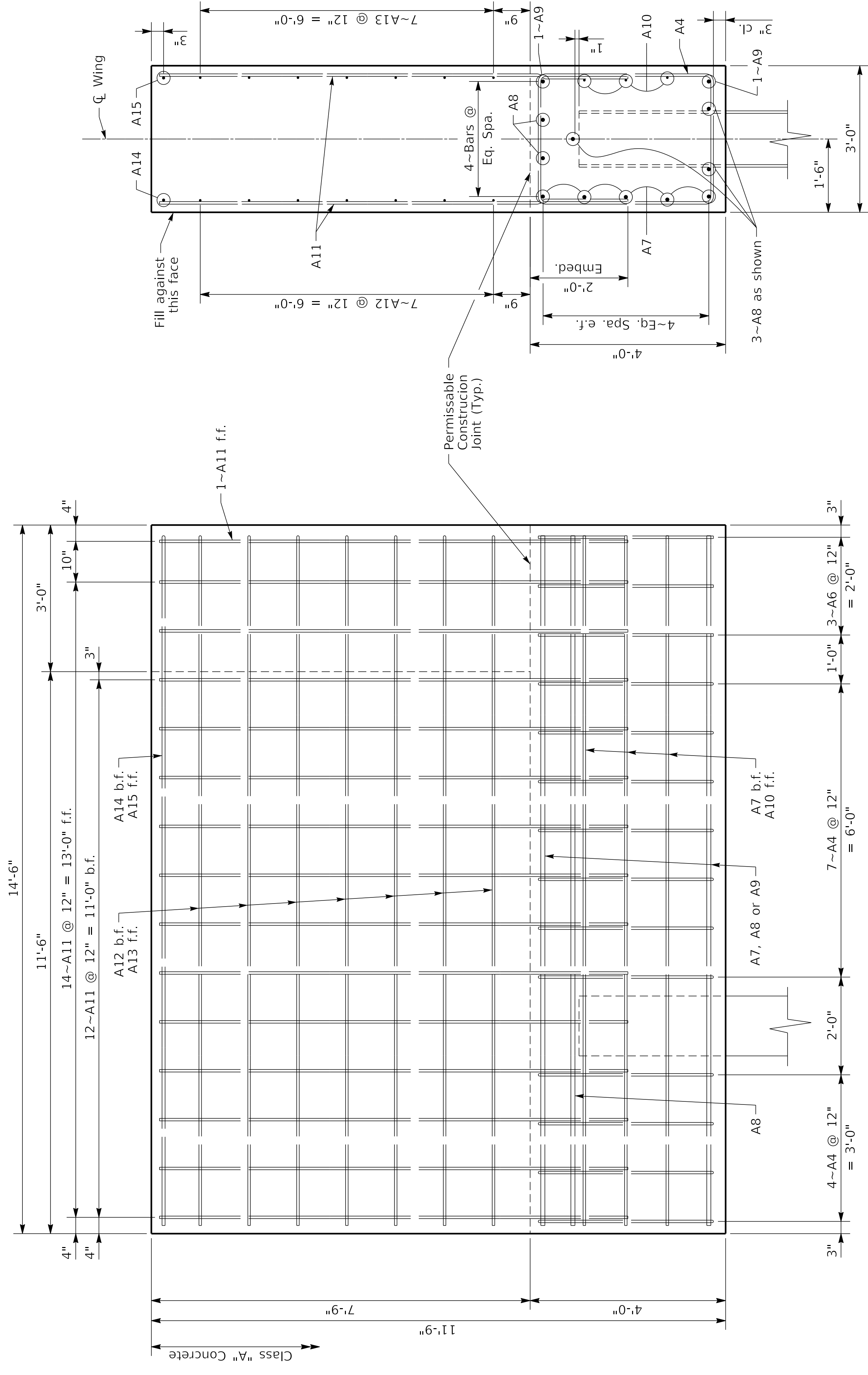

WING ELEVATION

SECTION THROUGH WING

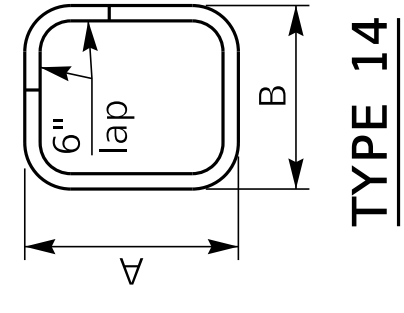
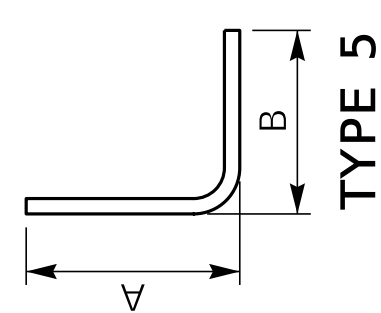
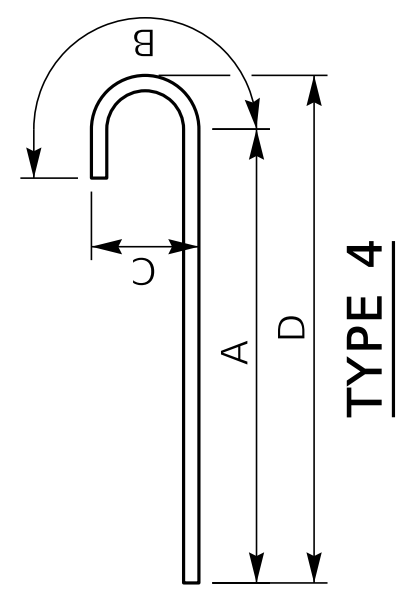
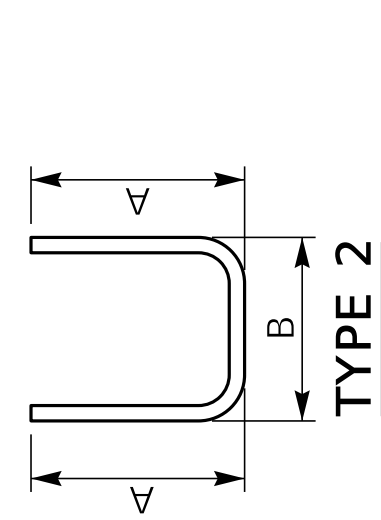

<p>COMMONWEALTH OF KENTUCKY DEPARTMENT OF HIGHWAYS</p>	<p>REVISION</p>	<p>DATE</p>	<p>PREPARED BY Division of Structural Design</p>	<p>CHECKED BY N. CORDTZ</p>	<p>ROUTE KY 581</p>	<p>ITEM NO. 12-8701.00</p>	<p>COUNTY OF LAWRENCE</p>	
	<p>DATE PLOTTED: 6-OCT-2023</p>	<p>DESIGNED BY: J. Van Zee</p>	<p>FILE NAME: I:\District1\12-8701.00 - Lawrence - KY 581 over Georges Creek\sketches\28818.dgn</p>	<p>DATE: August 2023</p>	<p>DESIGNED BY: J. Van Zee</p>	<p>ROUTE KY 581</p>	<p>SHEET NO. 57</p>	<p>DRAWING NUMBER 28818</p>
			<p>END BENT #1</p>	<p>CROSSING Georges Creek</p>				

BILL OF REINFORCEMENT

MARK	TYPE	NO.	SIZE	LENGTH	LOCATION	A	B	C	D
A1e	Str.	8	8	35'-8"	Cap.				
A2e	2s	3	8	37'-2"	Cap B.F.F.	35'-6 3/4"	1'-0"		
A3e	Str.	3	5	35'-8"	Cap F.F.				
A4e	14s	52	5	13'-0"	Cap/Wing Stirrup	3'-7"	2'-8"		
A5e	4	8	9	11'-5"	Cap Dowel Hook	9'-6 1/8"	1'-11"	0-11 3/4"	10'-0"
A6e	Str.	6	5	3'-7"	Wings F.F.				
A7e	5s	10	8	14'-11"	Wings B.F.F.	14'-1 3/8"	1'-0"		
A8e	Str.	10	8	14'-2"	Wings				
A9e	5s	4	8	16'-1"	Wings F.F.	14'-1 3/8"	2'-2"		
A10e	5s	6	5	16'-2"	Wings F.F.	14'-1 3/8"	2'-2"		
A11e	Str.	72	5	9'-7"	Wings Dowel				
A12e	5s	14	5	14'-3"	Wings B.F.F.	11'-7"	2'-9"		
A13e	5s	14	5	19'-3"	Wings F.F.	14'-1"	5'-3"		
A14e	5s	2	6	14'-2"	Top of Wings B.F.F.	11'-7"	2'-9"		
A15e	5s	2	6	19'-2"	Top of Wings F.F.	14'-1"	5'-3"		

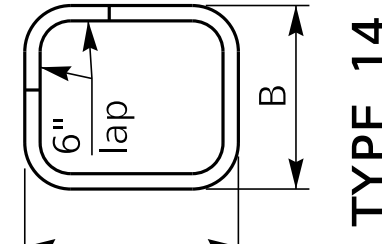
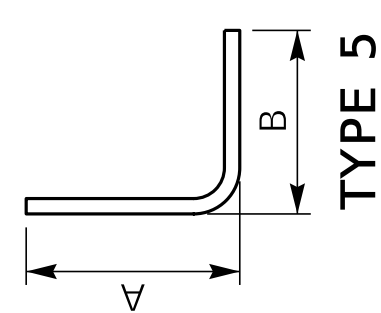
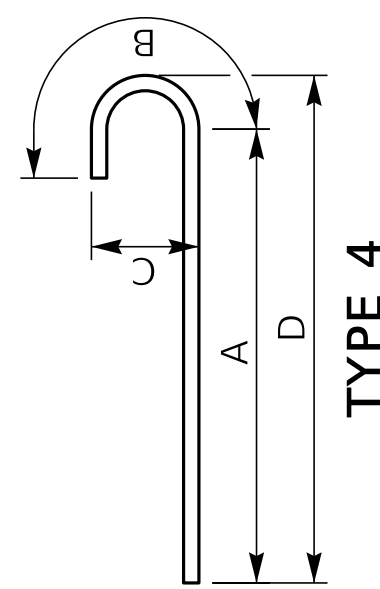
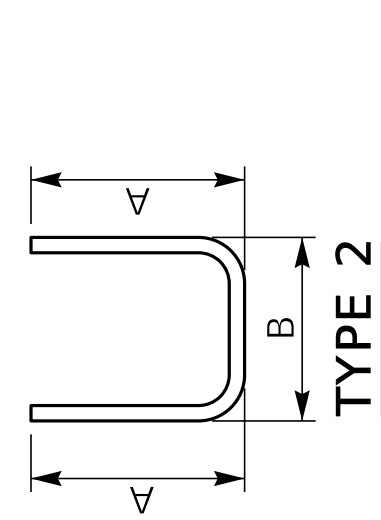
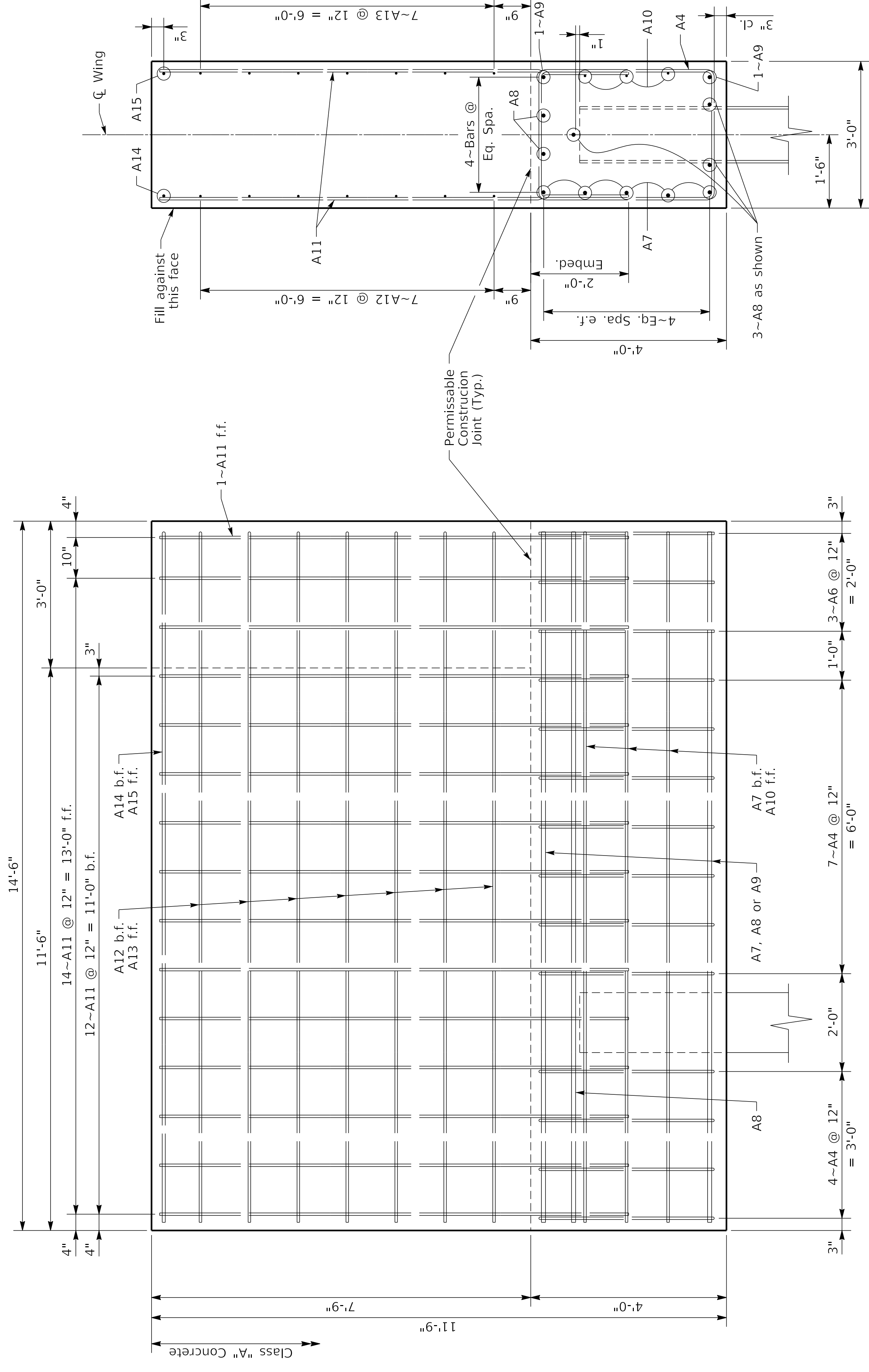

<p>COMMONWEALTH OF KENTUCKY DEPARTMENT OF HIGHWAYS</p>	<p>REVISION</p>	<p>DATE</p>	<p>PREPARED BY Division of Structural Design</p>	<p>DATE: August 2023 DESIGNED BY: J. Van Zee DETAILED BY: E. Downey</p>	<p>CHECKED BY N. CORDTZ J. Van Zee</p>	<p>ROUTE KY 581</p>	<p>ITEM NO. 12-8701.00</p>	<p>COUNTY OF LAWRENCE</p>
	<p>USER: earh.w.downey</p>	<p>DATE PLOTTED: 6-OCT-2023</p>	<p>FILE NAME: I:\District1\12-8701.00_Lawrence_KY 581 over Georges Creek\sketches\28818.dgn</p>	<p>END BENT #1</p>	<p>CROSSING Georges Creek</p>	<p>SHEET NO. 57</p>	<p>DRAWING NUMBER 28818</p>	

BILL OF REINFORCEMENT

MARK	TYPE	NO.	SIZE	LENGTH	LOCATION	A	B	C	D
B1e	Str.	8	8	35'-8"	Cap.				
B2e	2s	5	8	37'-2"	Cap B.F.F.	35'-6 3/4"	1'-0"		
B3e	Str.	3	5	35'-8"	Cap F.F.				
B4e	14s	52	5	13'-0"	Cap/Wing Stirrup	3'-7"	2'-8"		
B5e	4	8	9	11'-5"	Cap Dowel Hook	9'-6 1/8"	1'-11"	0-11 3/4"	10'-0"
B6e	Str.	6	5	3'-7"	Wings F.F.				
B7e	5s	10	8	14'-11"	Wings B.F.F.	14'-1 3/8"	1'-0"		
B8e	Str.	10	8	14'-2"	Wings				
B9e	5s	4	8	16'-1"	Wings F.F.	14'-1 3/8"	2'-2"		
B10e	5s	6	5	16'-2"	Wings F.F.	14'-1 3/8"	2'-2"		
B11e	Str.	72	5	9'-7"	Wings Dowel				
B12e	5s	14	5	14'-3"	Wings B.F.F.	11'-7"	2'-9"		
B13e	5s	14	5	19'-3"	Wings F.F.	14'-1"	5'-3"		
B14e	5s	2	6	14'-2"	Top of Wings B.F.F.	11'-7"	2'-9"		
B15e	5s	2	6	19'-2"	Top of Wings F.F.	14'-1"	5'-3"		

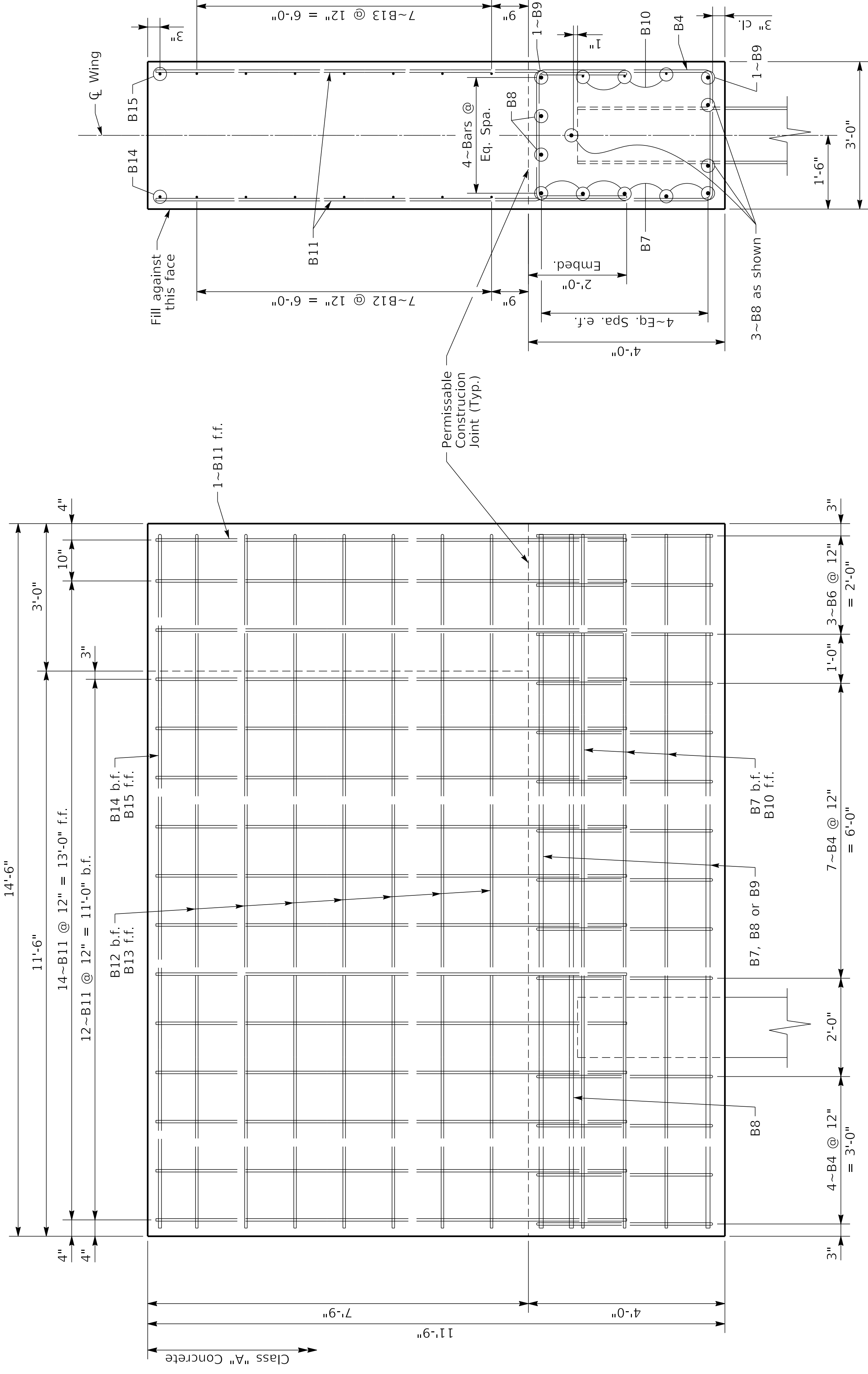

WING ELEVATION

SECTION THROUGH WING

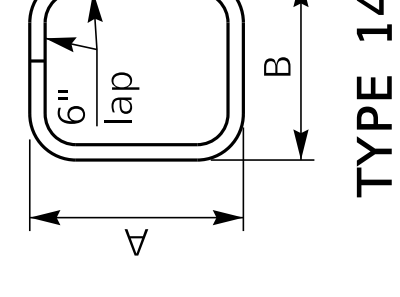
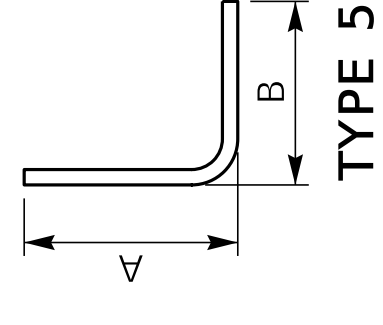
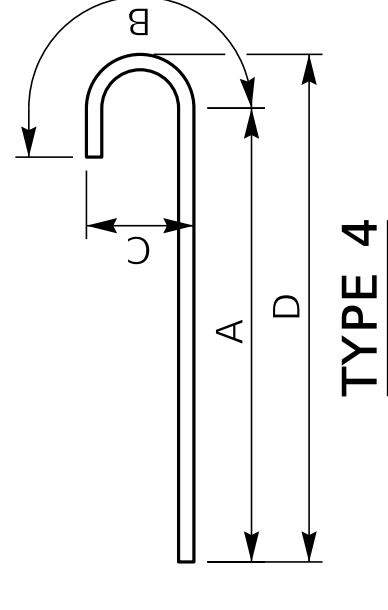
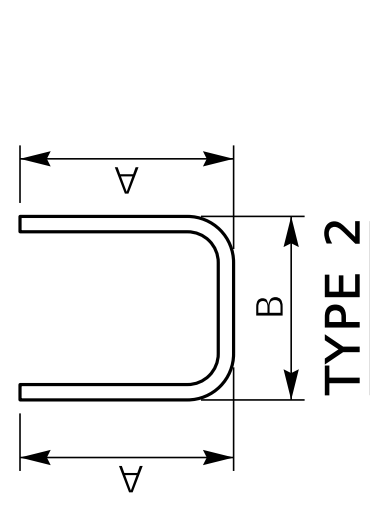

 COMMONWEALTH OF KENTUCKY DEPARTMENT OF HIGHWAYS	PREPARED BY Division of Structural Design	DATE August 2023	CHECKED BY N. CORDTZ	ROUTE KY 581	ITEM NO. 12-8701.00	COUNTY OF LAWRENCE
	REVISION	DESIGNED BY: J. Van Zee DETAILED BY: E. Downey	END BENT #2 CROSSING Georges Creek	SHEET NO. S9	DRAWING NUMBER 28818	

BILL OF REINFORCEMENT

MARK	TYPE	NO.	SIZE	LENGTH	LOCATION	A	B	C	D
B1e	Str.	8	8	35'-8"	Cap.				
B2e	2s	5	8	37'-2"	Cap B.F.F.	35'-6 3/4"	1'-0"		
B3e	Str.	3	5	35'-8"	Cap F.F.				
B4e	14s	52	5	13'-0"	Cap/Wing Stirrup	3'-7"	2'-8"		
B5e	4	8	9	11'-5"	Cap Dowel Hook	9'-6 1/8"	1'-11"	0-11 3/4"	10'-0"
B6e	Str.	6	5	3'-7"	Wings F.F.				
B7e	5s	10	8	14'-11"	Wings B.F.F.	14'-1 3/8"	1'-0"		
B8e	Str.	10	8	14'-2"	Wings				
B9e	5s	4	8	16'-1"	Wings F.F.	14'-1 3/8"	2'-2"		
B10e	5s	6	5	16'-2"	Wings F.F.	14'-1 3/8"	2'-2"		
B11e	Str.	72	5	9'-7"	Wings Dowel				
B12e	5s	14	5	14'-3"	Wings B.F.F.	11'-7"	2'-9"		
B13e	5s	14	5	19'-3"	Wings F.F.	14'-1"	5'-3"		
B14e	5s	2	6	14'-2"	Top of Wings B.F.F.	11'-7"	2'-9"		
B15e	5s	2	6	19'-2"	Top of Wings F.F.F.	14'-1"	5'-3"		

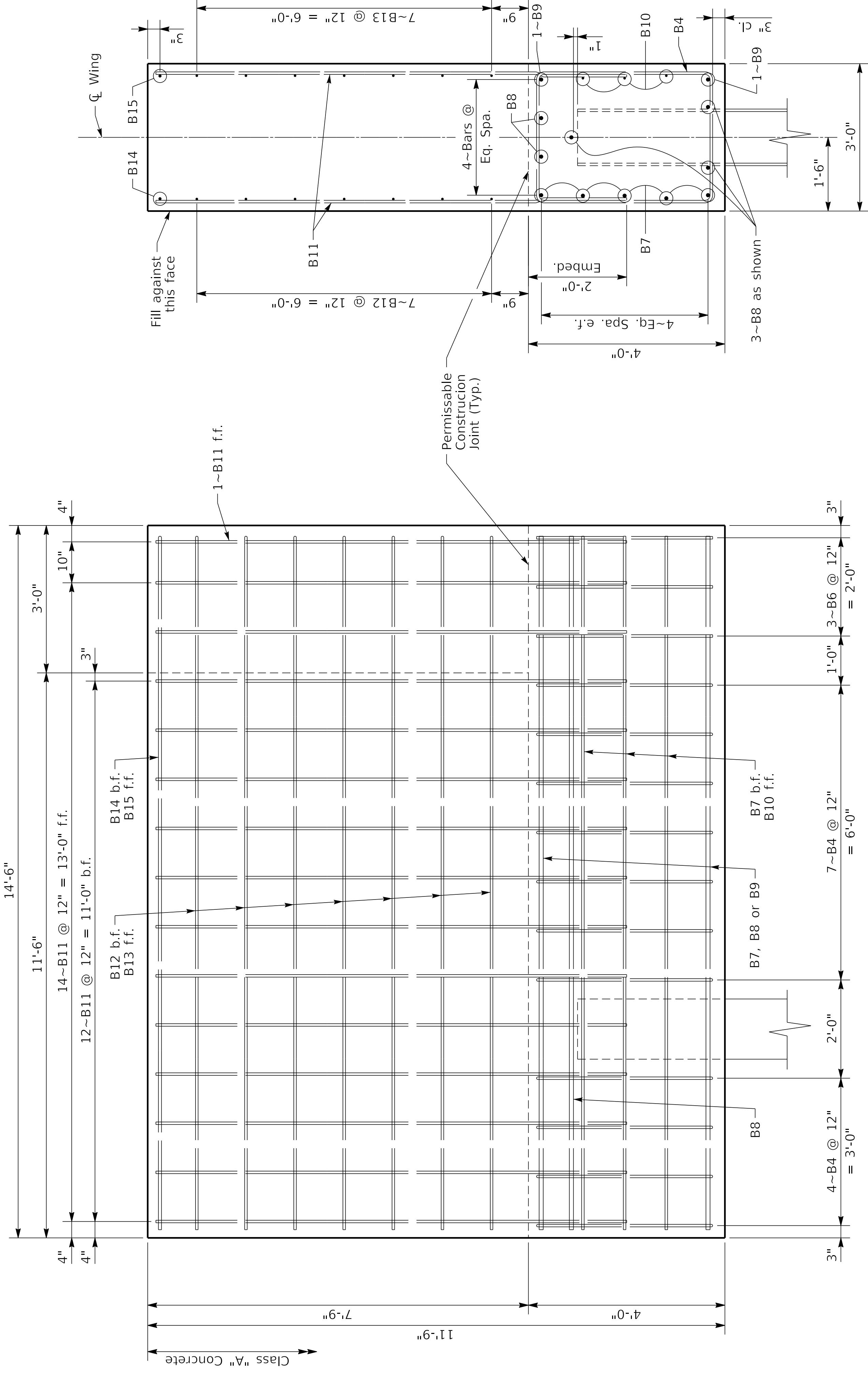

WING ELEVATION

SECTION THROUGH WING

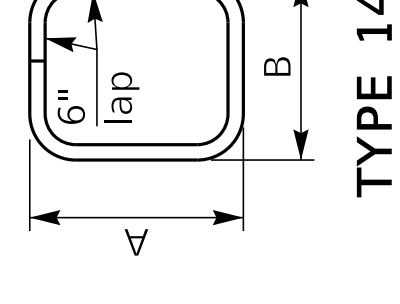
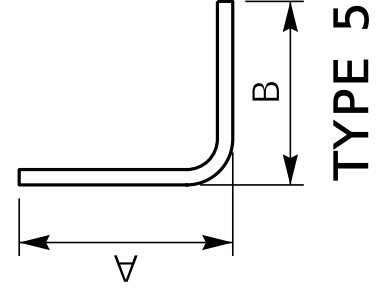
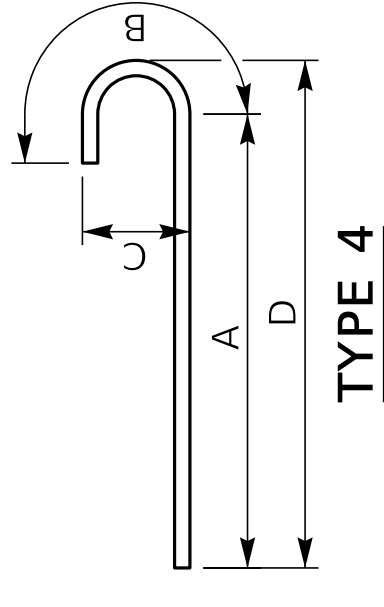
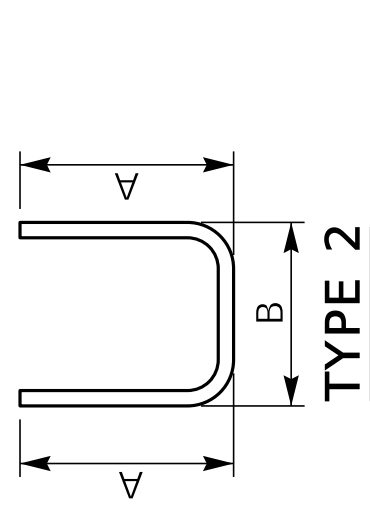

<p>COMMONWEALTH OF KENTUCKY DEPARTMENT OF HIGHWAYS</p>	<p>REVISION</p>	<p>DATE</p>	<p>PREPARED BY Division of Structural Design</p>	<p>DATE: August 2023 DESIGNED BY: J. Van Zee DETAILED BY: E. Downey</p>	<p>CHECKED BY N. CORDTZ J. Van Zee</p>	<p>ROUTE KY 581</p>	<p>ITEM NO. 12-8701.00</p>	<p>COUNTY OF LAWRENCE</p>
	<p>USER: earlw.downey</p>	<p>DATE PLOTTED: 6-OCT-2023</p>	<p>FILE NAME: I:\District12\12-8701.00 - Lawrence - KY 581 over Georges Creek\sketches\28818.dgn</p>	<p>END BENT #2</p>	<p>CROSSING Georges Creek</p>	<p>SHEET NO. S9</p>	<p>DRAWING NUMBER 28818</p>	